

NOTICE DE MONTAGE LIT DE RELAXATION

FOURNITURES CARTONS - (2 SOMMIERS)



2x4
Vis poêlier
HM8x16
à conserver pour montage
KIT ENCADREMENT
embellissage rentrant
(SELON OPTION)



2x4
Vis poêlier
(EN OPTION)



2x4

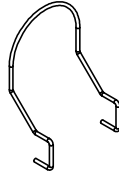

ou

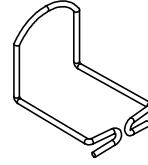

2x2

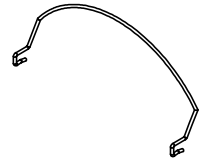

2x1

1 - MONTAGE PIEDS

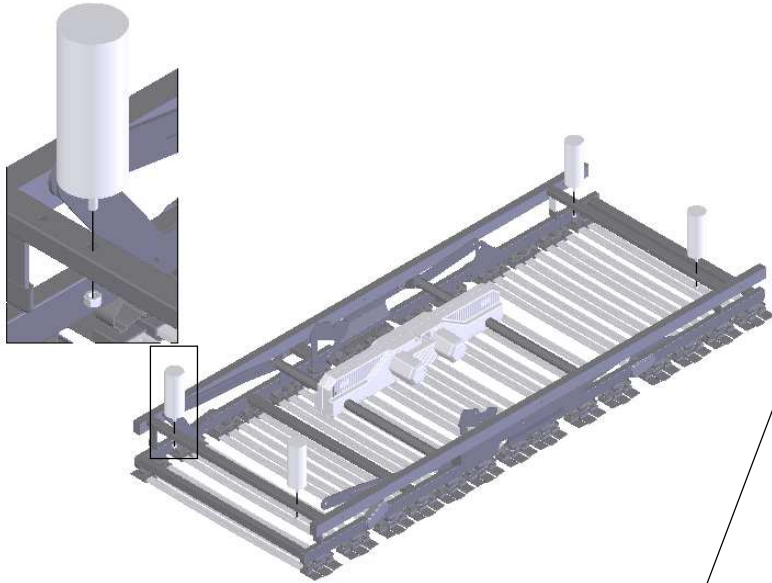

ou

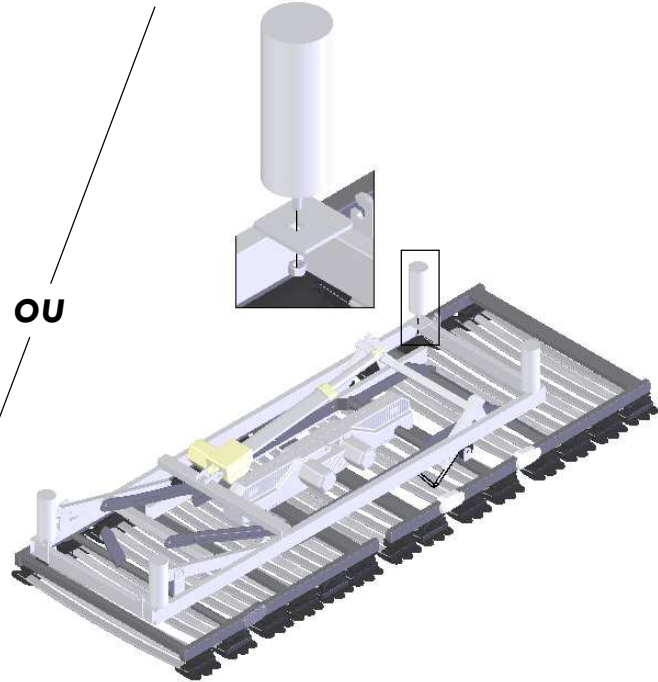

2 - MONTAGE ACCESSOIRES DE JUMELAGE

MODELE caisses bois



FAST LINK Standard
avec bande auto-agrippante
(Jeu de 2 pcs)

BREVETE

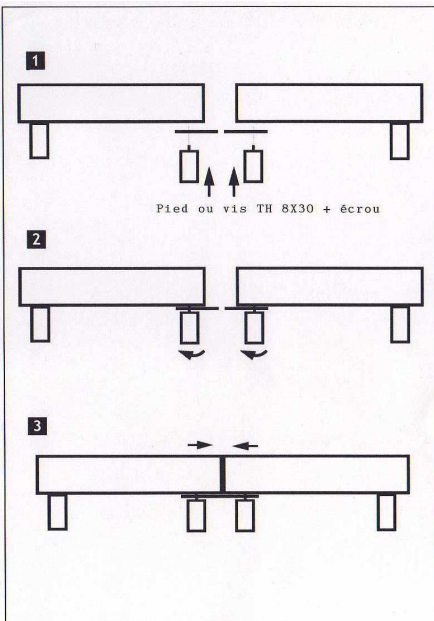
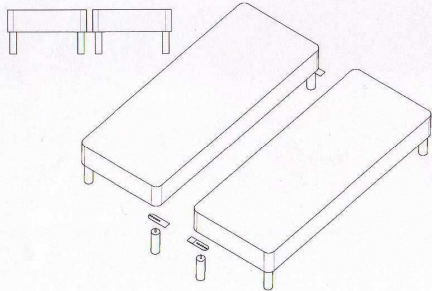

MODELE encastrable

Vis Poelier HC 8x50 (x2)
Ecrou HM8 (x2)

ou

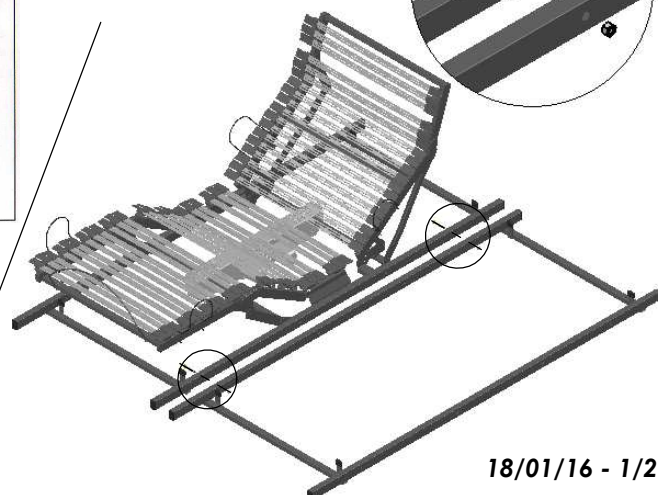

3 - MONTAGE ARRETS MATELAS

Retourner les lits.

Lever la tête et le pied au maximum.

Monter les arrêts matelas.

**ARRÊT MATELAS
MODELE NOIR MAT
à frapper**

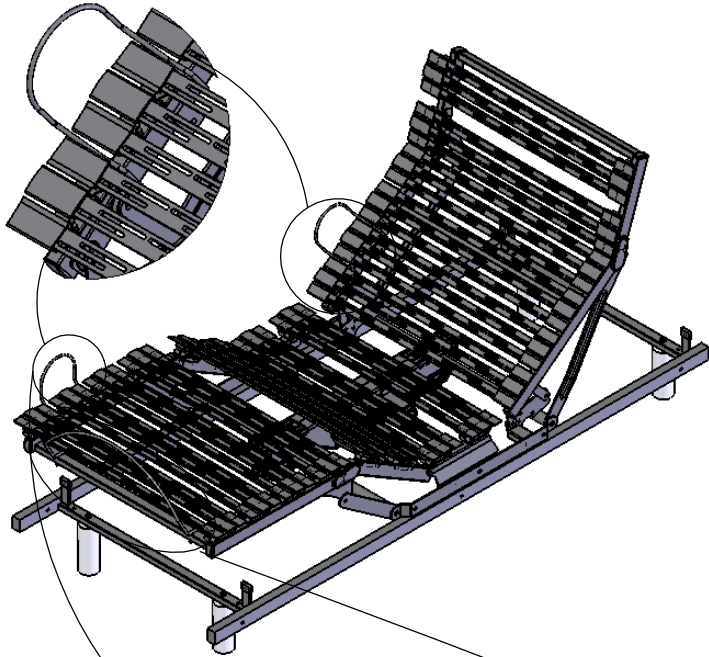

**ARRÊT MATELAS
MODELE CHROME
à pincer sur 1 latte**

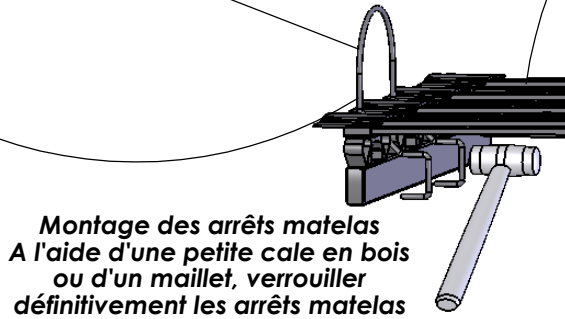
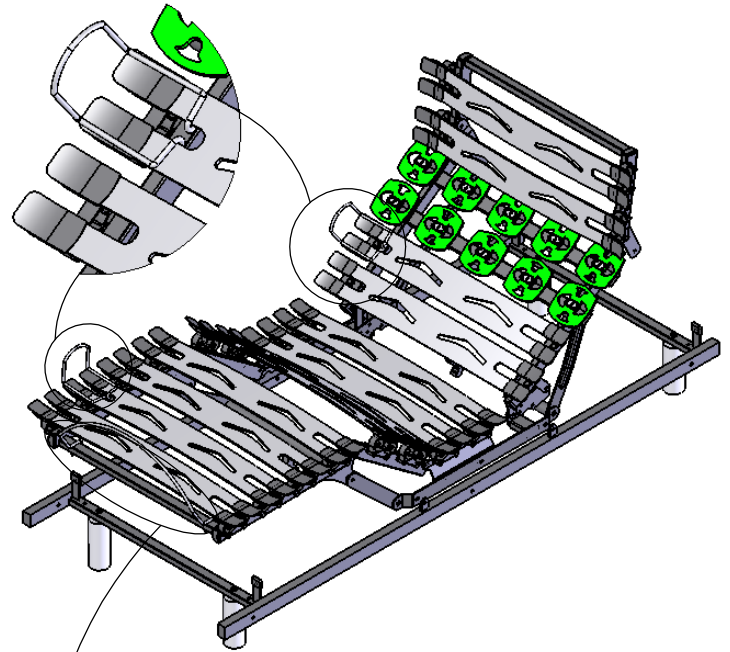

**Montage des arrêts matelas
A l'aide d'une petite cale en bois
ou d'un maillet, verrouiller
définitivement les arrêts matelas**

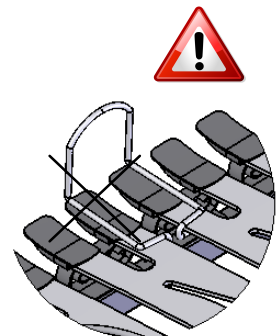
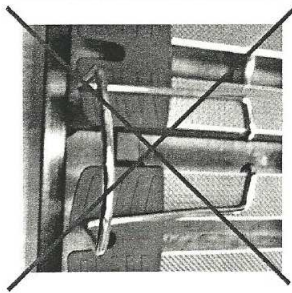
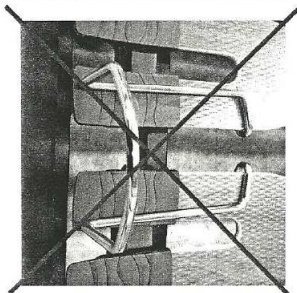
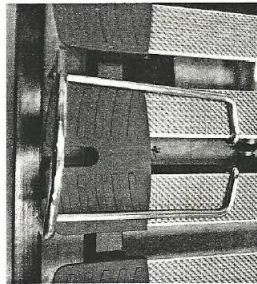
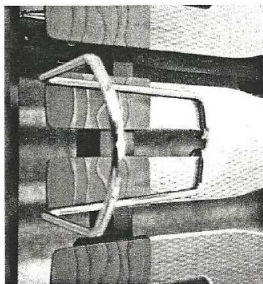

**NE PAS MONTER
L'ARRÊT MATELAS
ENTRE LES LATTES**